

KATYBAR® DOOR VAULT

INDUSTRIAL LOCK SYSTEM

MUST BE DONE FIRST

UNPACKING INSTRUCTIONS

The Handle is locked during shipping.

There are two internal shipping screws to protect rack and pinion during shipping.
These shipping screws must be removed to operate handle to move right and left.



1 Remove all screws right and left on both sides of Katy Bar.



2 Using screwdriver, pry upward to separate the Katy Bar from the door rail.



3 Locate the two red shipping screws on each end of Katy Bar in bottom rail.



4 Use provided wrench to remove the shipping screws and discard.

The handle should move freely now and bolts should extend evenly and smoothly with control of handle moving right and left.

You are now ready to begin installation on door.

If there is any resistance while moving handle right or left, or if bolts are not moving outward and inward... please **DO NOT continue with installation and contact us.**

KATYBAR[®] DOOR VAULT

INDUSTRIAL LOCK SYSTEM

BEFORE INSTALLATION CHECK LIST

- 1 Make sure you have all components in Parts List before installation.
- 2 Make sure your Katy Bar functions properly by sliding handle to engage lock bolts outward completely and slide handle to disengage lock bolts inward and into housing. The sliding handle should move freely and smoothly. While lock bolts are out in a locked position, hold up against door at desired installation area to be certain the lock bolts freely clear the door trim.
- 3 Make sure your door meets the Door Requirements before installation.

PARTS LIST

1- Katy Bar with End Caps	5- 1/4" X 20 X 21/2" S.S. Bolts	1- 1/4" X 3" Drill Bit
1- Outer Door Rail with End Caps	5- 1/4" X 20 S.S. Nylon Nuts	1- Drill Block
1- Outer Door Rail Cover	1- 5/32" Drill Bit	1- Hex Wrench
1- Outer Door Rail Seal		

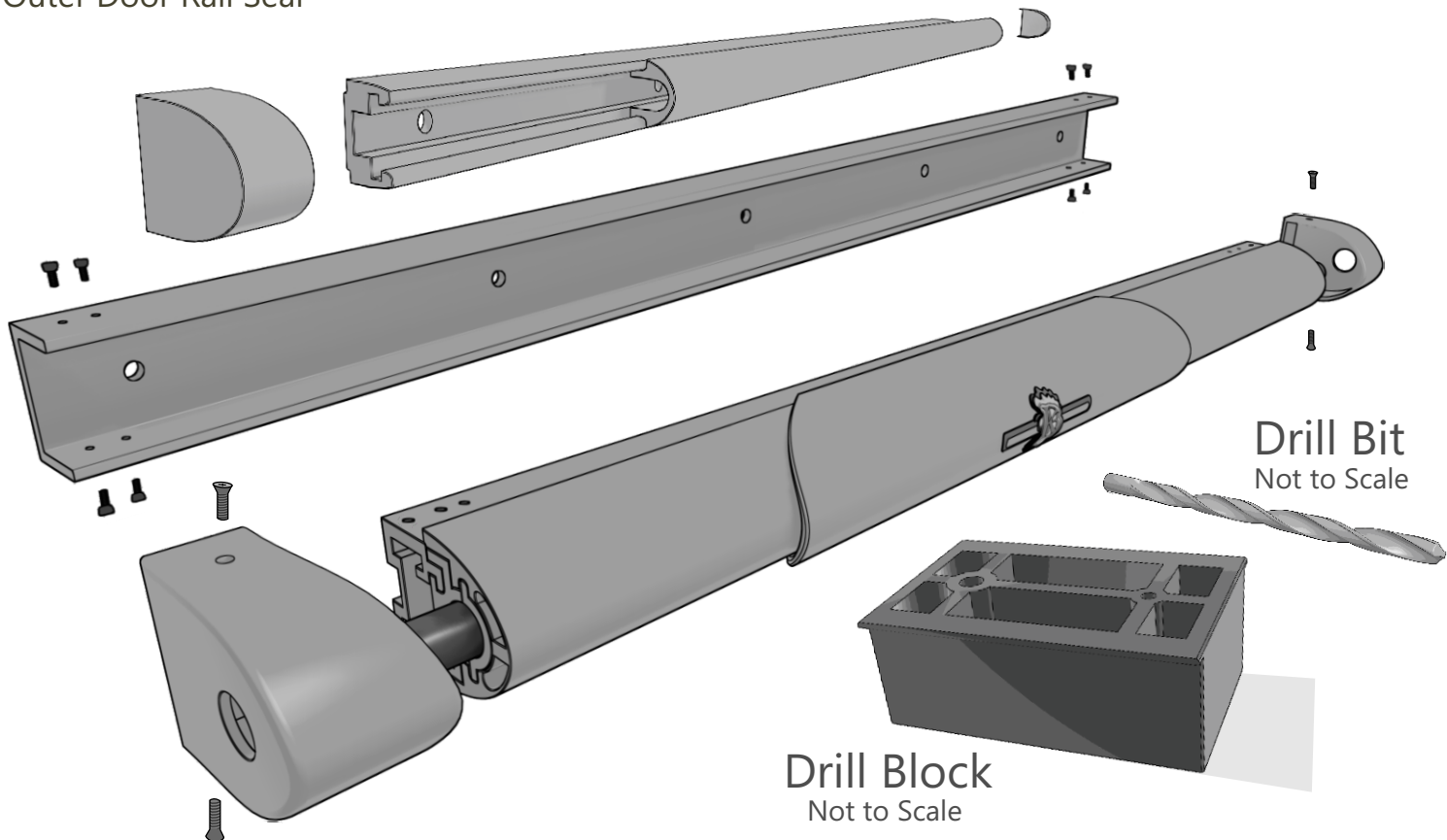

ATTENTION
**OUT-SWINGING
DOOR INSTALLATION**



NOTE* Installation Requires Larger Drill Bits NOT PROVIDED.
Before beginning Installation be sure to have a complete set of
Drill Bits ranging from 3/32 inch to 3/4 inch in size.

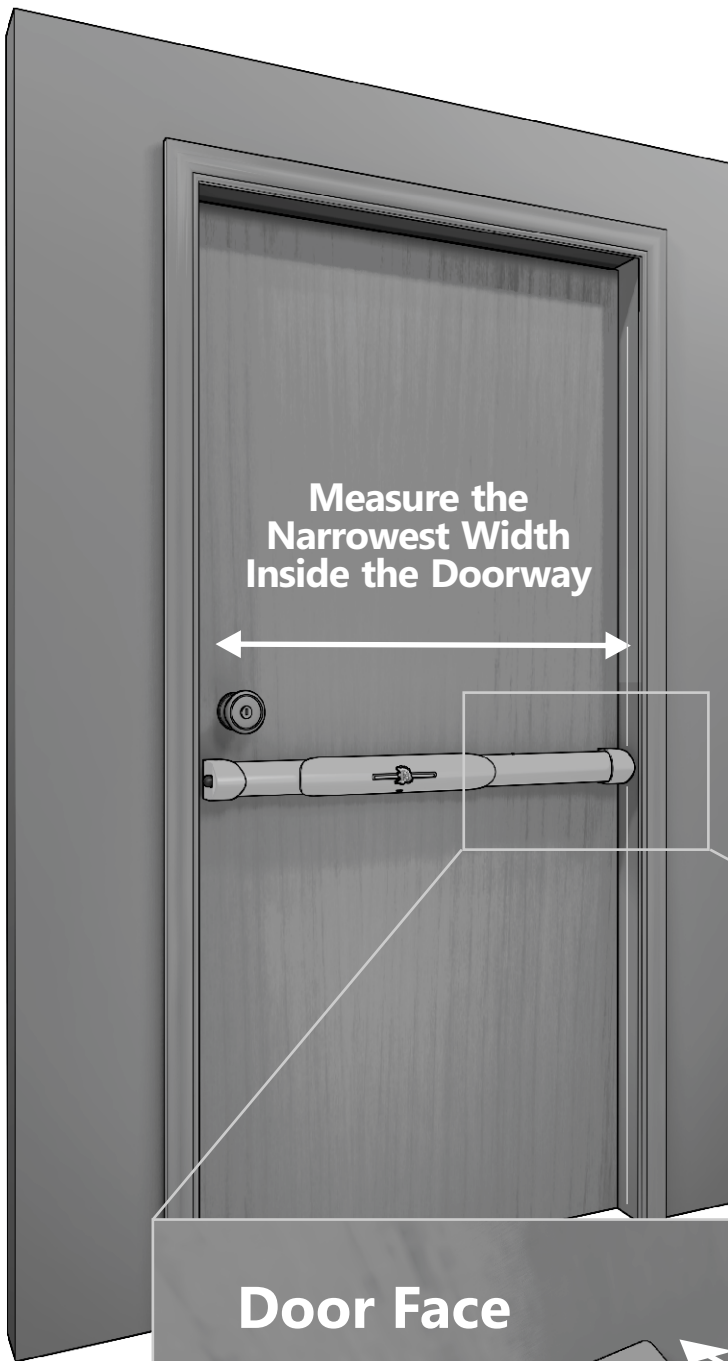

The Door Vault System Installs Inside the Door Frame. The Katybar Vault must fit inside the **NARROWEST** section of the, inside frame or any other portion of the door.

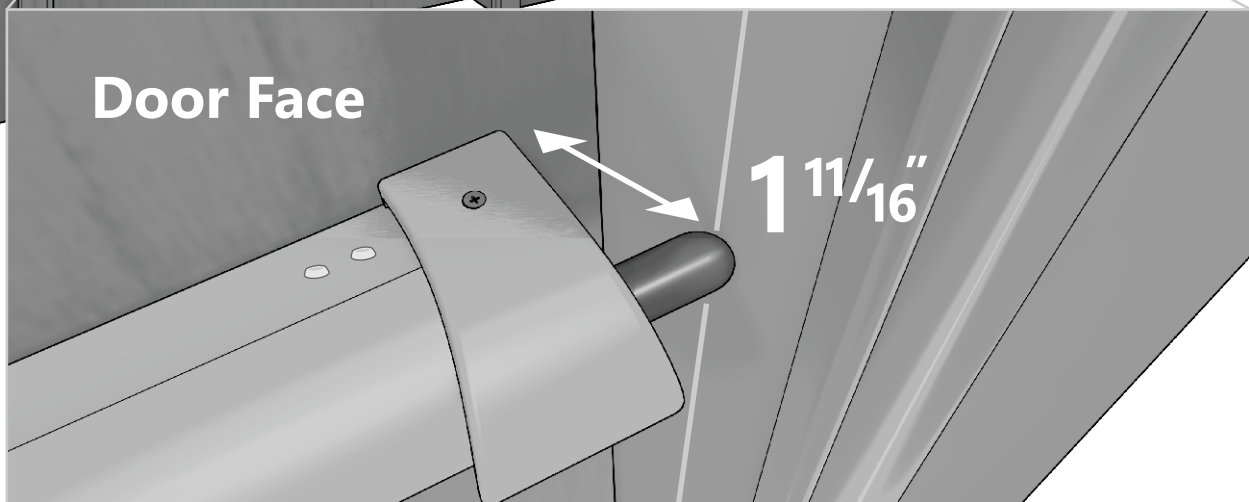

- 1** The distance between the narrowest points measuring horizontally of the door frame.
- 2** For Out-Swinging Installations without door frame protrusions and horizontal width of door frame installation is straightforward.

Some Doors have a Backstop Moulded Into the Frame

- 3 The distance from face of door to the center of lock bolt is 1 11/16 inches. Doorframe is smooth on both sides and will not interfere with lock bolt installation through frame.
- 4 However, some door ways have a backstop moulded into the frame. The arrow indicates position of where the lock bolt would need to be installed. This may interfere with lock bolt installation. To be certain you will not have issues, you will need a door rail spacer to move lock bolt away from moulding of backstop in the frame.
- 5 With door rail spacer in place, the center of lock pin is now located at 2 1/16

Backstop Moulded
Into the Frame

Rail Spacer

If you determine a Door Rail Spacer would help with installation, one can be added to order in cart.

2 1/16"



ATTENTION

OUT-SWINGING DOOR

There are some specific minimum requirements for Out-Swinging Doors.

See the **OUT-SWINGING DOOR REQUIREMENTS** section for details.

Out-Swinging Installation goes inside the Door Frame, **Wall Anchors Are Not Required**

KATYBAR/DOOR PREP

- 1** Remove all screws (12) on Katy Bar® Vault and remove End Caps and set aside.
- 2** Separate Katy Bar® Vault from Door Rail by pulling Katy Bar® up from Door Rail.

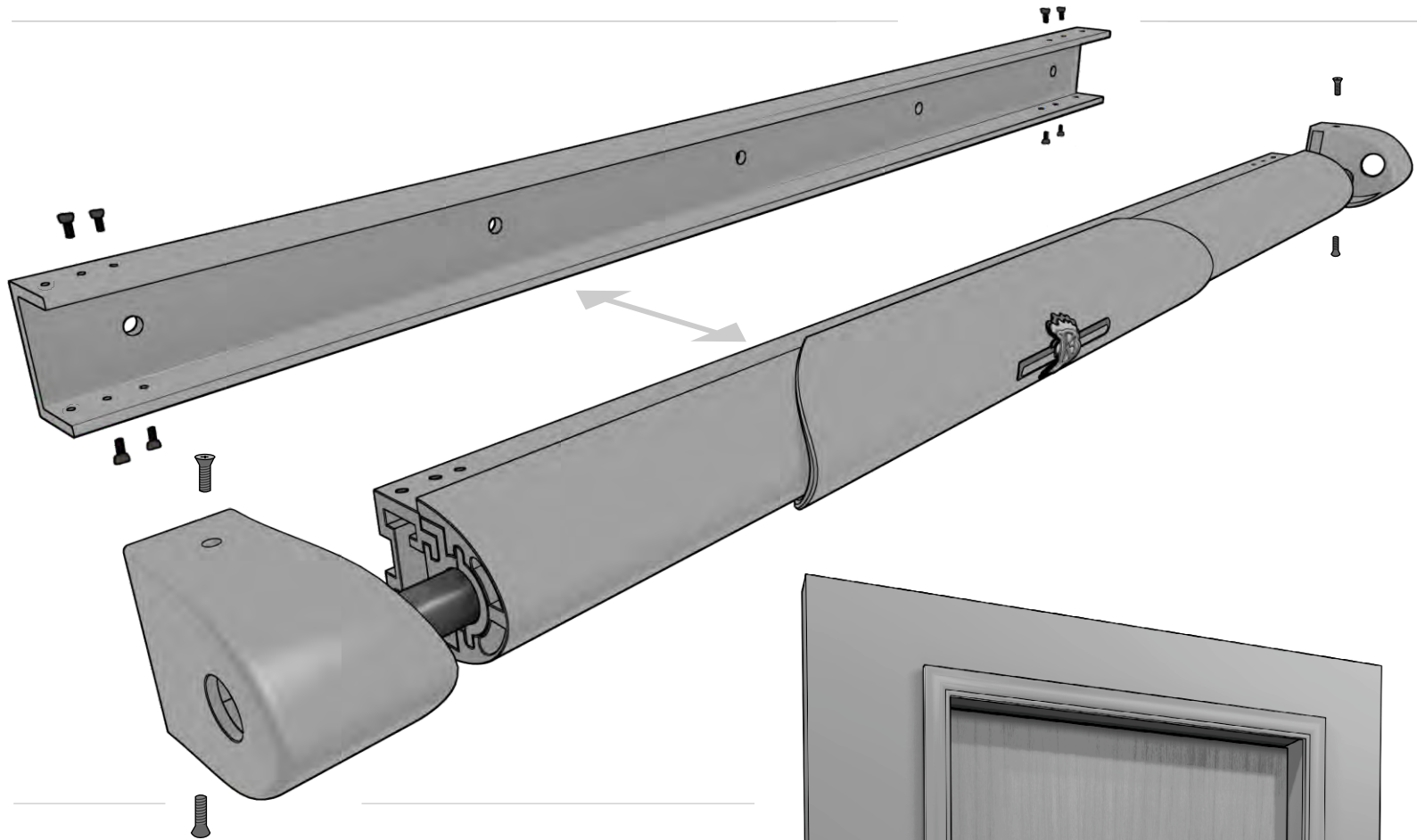

- 3** Determine area of door for Katy Bar® Vault location. Area on door should be; below door knob, smooth all the way across, at least two inches down and away from door knob AND hinge, and more than 33 inches from floor.
- 4** Measure width of door and mark the exact center.
- 5** Use a punch to create indent of mark at exact center.



DOOR 1ST HOLE / CENTERING

- 1** Install provided 5/32" drill bit into drill and drill through 5/32" hole in provided Drill Block.
- 2** Align 5/32" drill bit through Drill Block with indent at center of door.

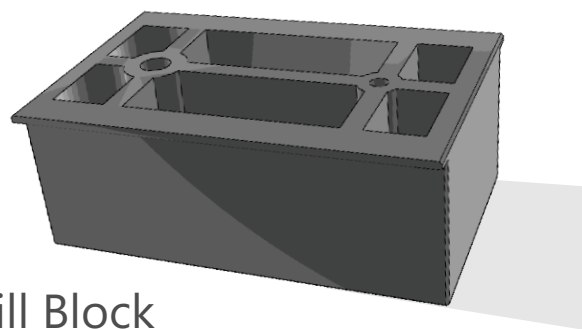

*Drill Block

Used to help center 5/32" then 1/4" wider hole

- 3** Drill Block MUST be flat and firmly pressed against door at all time to ensure straight drilling through door.
- 4** While holding Drill and Drill Block in flat position, drill 5/32" hole through door
- 5** Attach provided 1/4 " drill bit into drill and drill through 1/4" hole of Drill Block.
- 6** While holding Drill and Drill Block in flat position, drill 1/4" hole through 5/32" hole in door.



RAIL PLACEMENT/LEVELING

- 1 Place one 1/4"-20 SS bolt through Center hole of Door Rail and door.

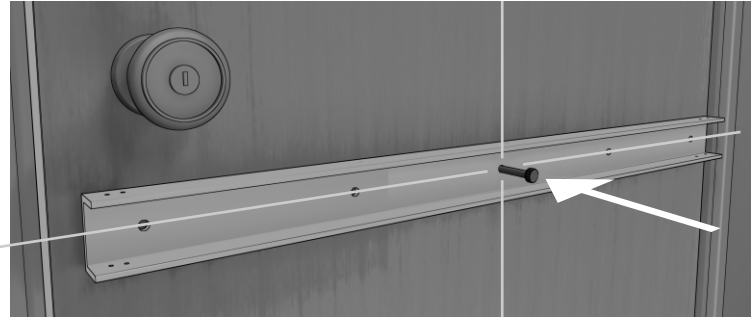
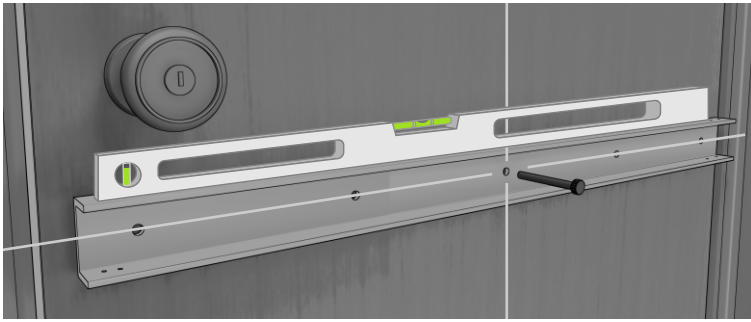

- 2 Position bolt at center hole through Outer Door Rail Seal with flat portion of seal toward door. Open door midway to make installation easier.

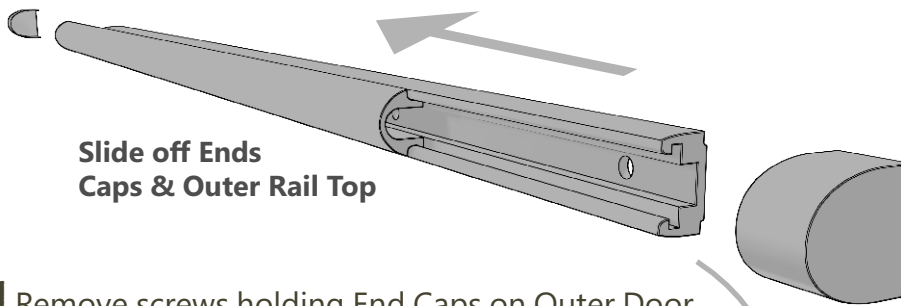

- 3 Remove screws holding End Caps on Outer Door Rail. Remove End Caps and set aside.

- 4 Carefully slide Top of Outer Door Rail from its Base, and set Top aside.

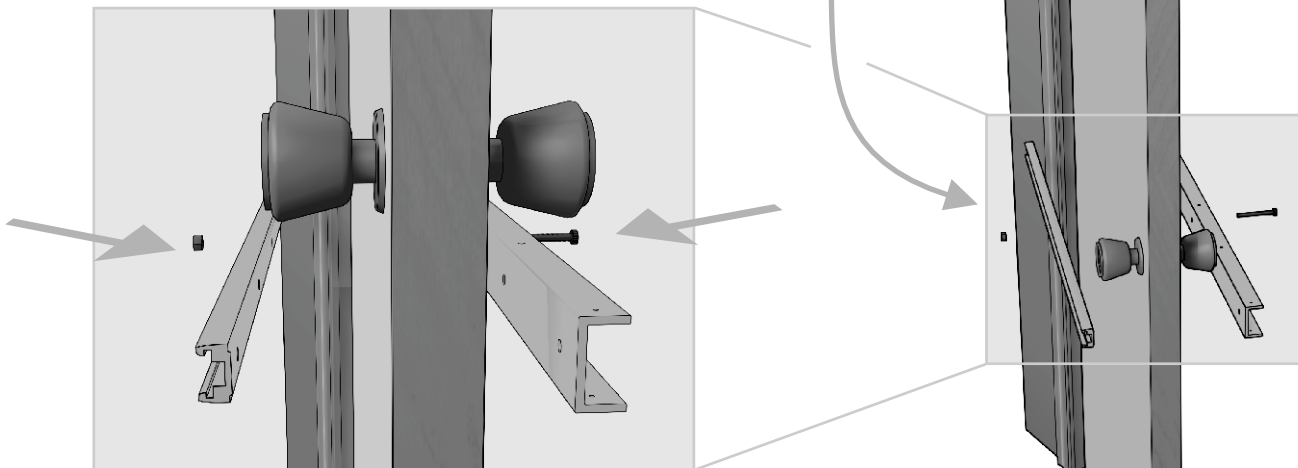

- 5 Position bolt through door at center hole through Outer Door Rail Base with flat side toward door.

- 6 Attach provided 1/4" SS nut onto bolt and screw bolt just till nut sets into nut groove of Outer Door Rail Base.

- 7 Place a level on top of inner Door Rail on inside of door and position Door Rail until completely level.

- 8 Mark door at nearest to you Door Rail hole while Door Rail is exactly level. Use a punch to create indent of mark at nearest Door Rail hole.

RAIL PLACEMENT

- 1** Open door to allow the outer Top Rail to slide into Base rail that is attached to the door. Align all the edges of Top and Base Rails.
- 2** Replace End Caps and attach firmly with screws.
- 3** Drill Block MUST be flat & firmly pressed into Door Rail to ensure straight drilling through door.
- 4** While holding Drill & Drill Block into Door Rail in flat position, drill 5/32" hole through door.
- 5** Attach provided 1/4 " drill bit into drill and drill through 1/4" hole of Drill Block.
- 6** While holding Drill and Drill Block into Door Rail in flat position, drill 1/4" hole through 5/32" hole in door.
- 7** Place one 1/4"-20 SS bolt through nearest hole in Door Rail and through just drilled hole in door, Outer Door Rail Seal, and Outer Door Rail Base.
- 8** Attach provided 1/4" SS nut onto bolt and screw bolt till nut sets into nut groove in rail. Screw both 1/4" bolts till inner and outer rails are snug against door.
- 9** Find center of each remaining holes in Door Rail, mark and punch to create indent. Repeat the process of 5/32", then 1/4" hole with Drill Block for the remaining holes checking level and hand snug 1/4"-20 SS bolt & nut as each hole is completed.

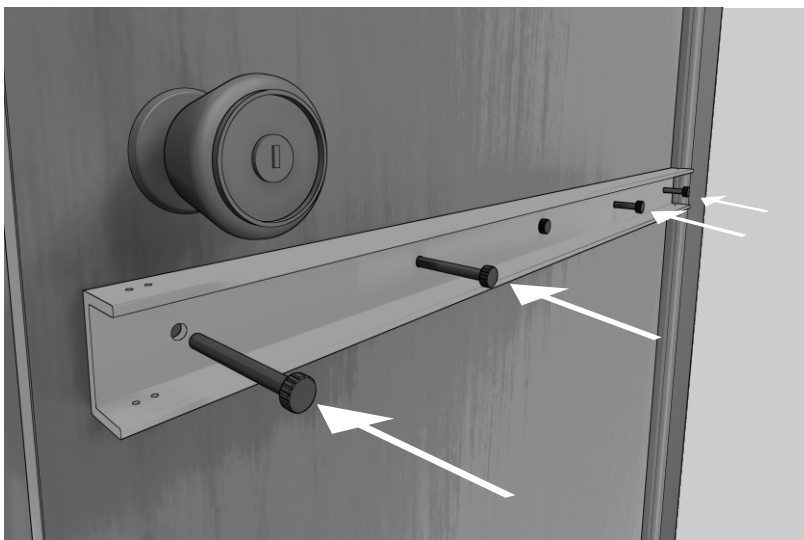

INTERIOR ASSEMBLY

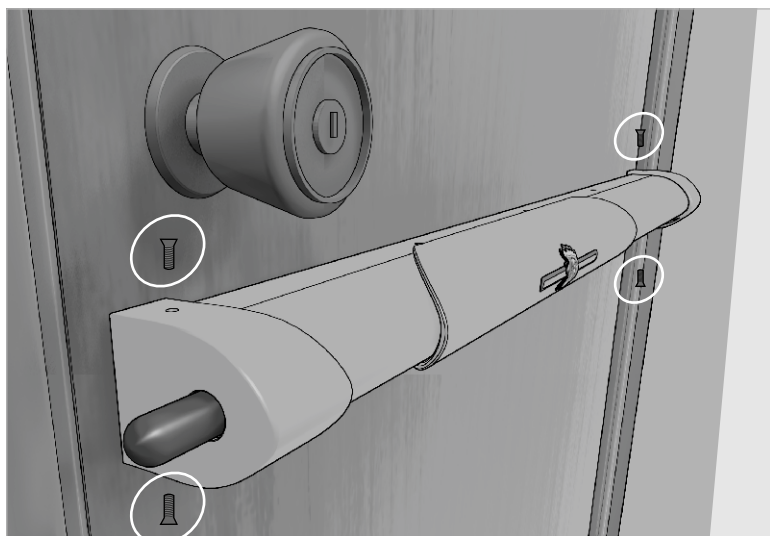
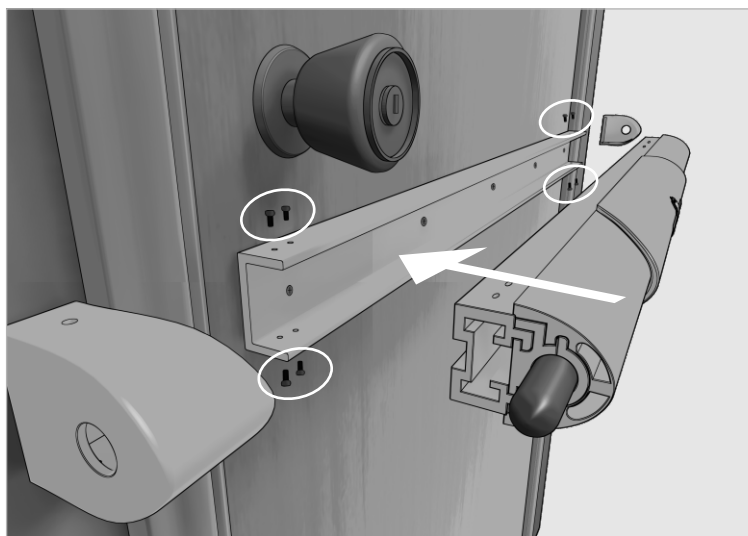

- 1** With inner and outer rails attached firmly to door, slide Outer Top Rail into Outer Base Rail. Attach Outer End Caps and screws.
- 2** Open the door and Replace End Caps and all screws (8) to secure Katy Bar® Vault to Door Rail.

! It is critical to drill holes through casing straight & level in order for bolts to move freely into frame.



- 1 Mark exact center position on doorway frame by sliding handle outward with a bit of force to cause slide bolts to "tap" onto doorway frame. Repeat this motion several time till a "tap" mark is left on doorway frame left by the slide bolts. This is the exact center of slide bolts and where the frame needs to be drilled out to allow for slide bolts to move freely into doorway frame.

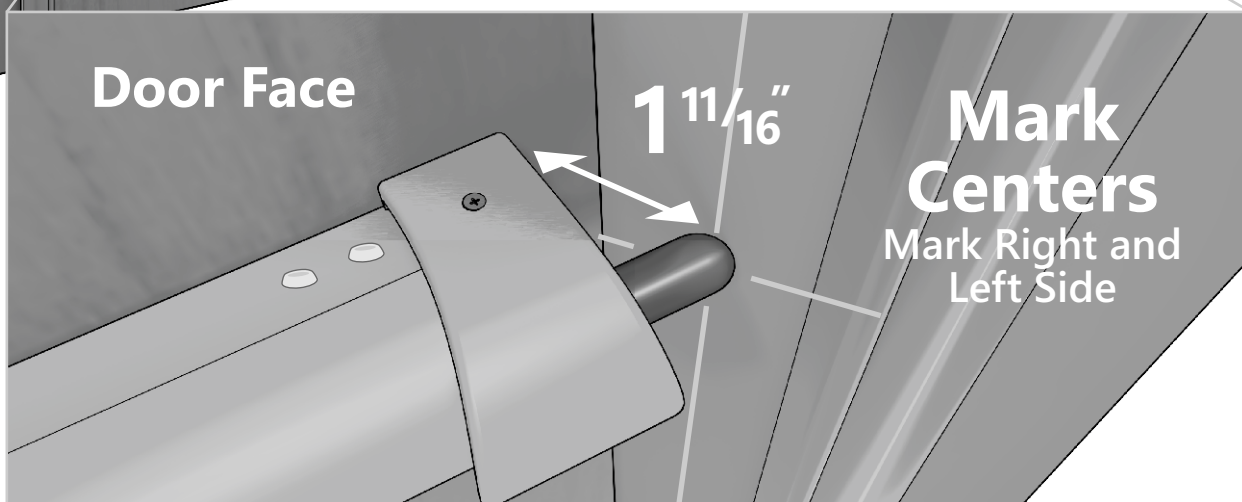

- 2 At the marked locations on frame, use the hammer and punch to create indent at exact center for drilling
- 3 Open Door Completely to allow access to doorway frame.

- 1 The use of the Drill Block will be needed to drill the 5/32 inch and the 1/4 inch holes pressed flatly and aligned for exact center into frame, on each side, as it was used earlier on door.

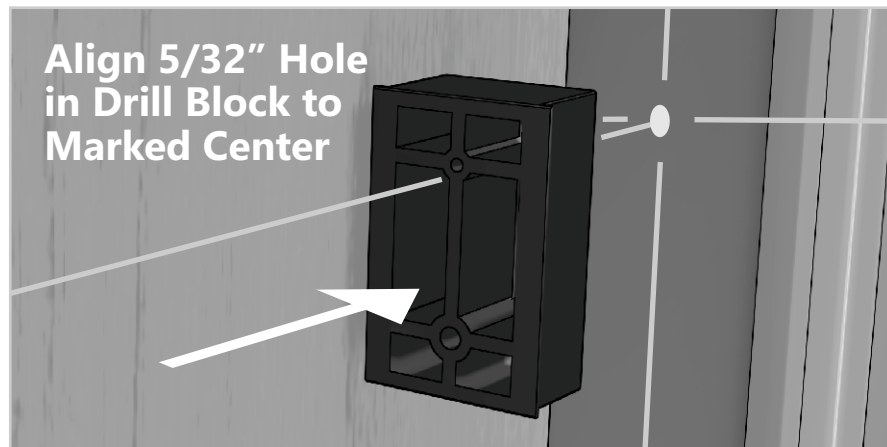

- 2 Attach 5/32 inch drill bit into drill and drill through 5/32 inch hole in drill block. Align 5/32 inch drill bit with punch indent and with drill block flat against door frame, drill 5/32 inch hole into frame. Remove drill bit.

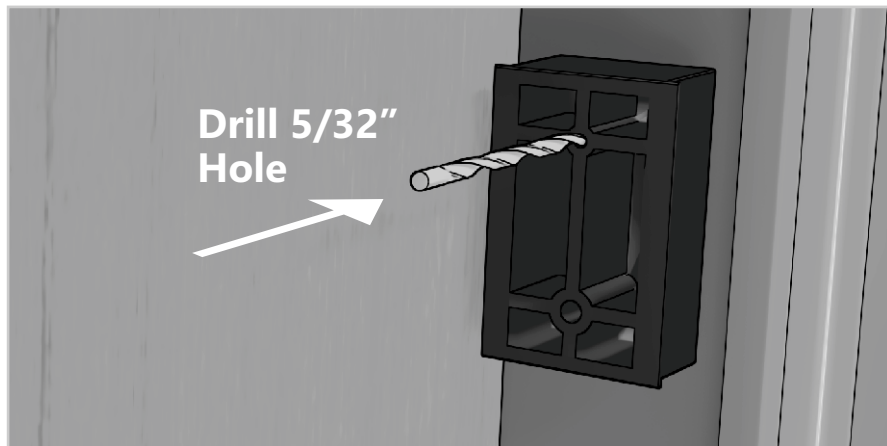

- 3 Attach 1/4 inch drill bit into drill and drill through 1/4 inch hole in drill block.

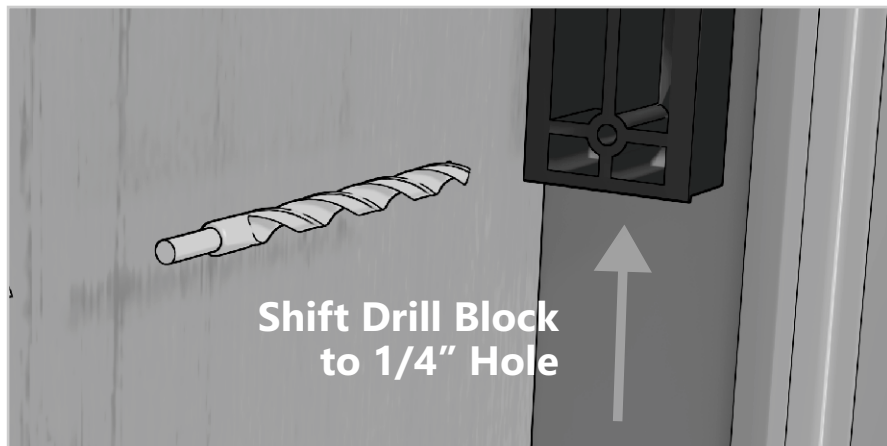

- 4 Align 1/4 inch drill bit with 5/32 inch hole and with drill block flat against door frame, drill 1/4 inch hole in frame. Remove drill bit
- 5 Once large holes are drilled, close door completely and slide handle to cause the slide bolts to move outward and into holes. If one or both slide bolts meet resistance, determine the point needing to be drilled out to eliminate the resistance. Open door completely and using the last drill bit, drill out to eliminate the resistance. Repeat until both slide bolts move freely and smoothly into frame.

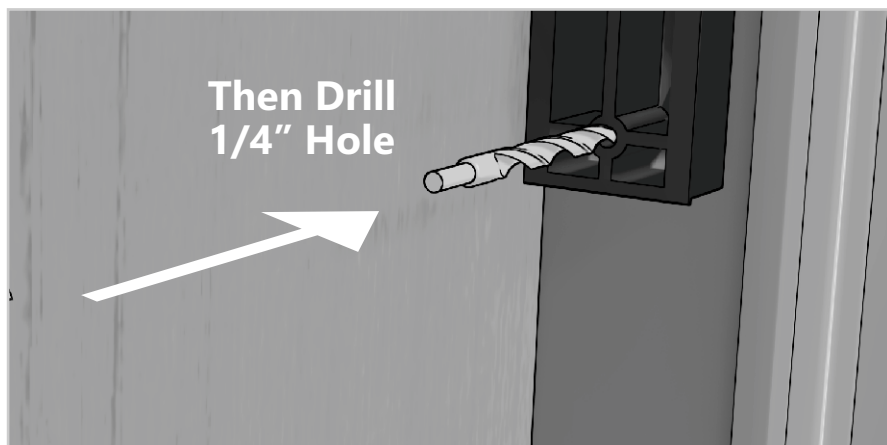

- 1** Open door completely to allow attachment of the Frame Covers.
- 2** Place Frame Cover into position covering the hole on the frame while allowing slide bolt to move freely through it.
- 3** Align Frame Cover and mark screw holes with marker. Use a hammer and punch to indent exact location for drill bit. Drill with 3/32" drill bit (not provided)

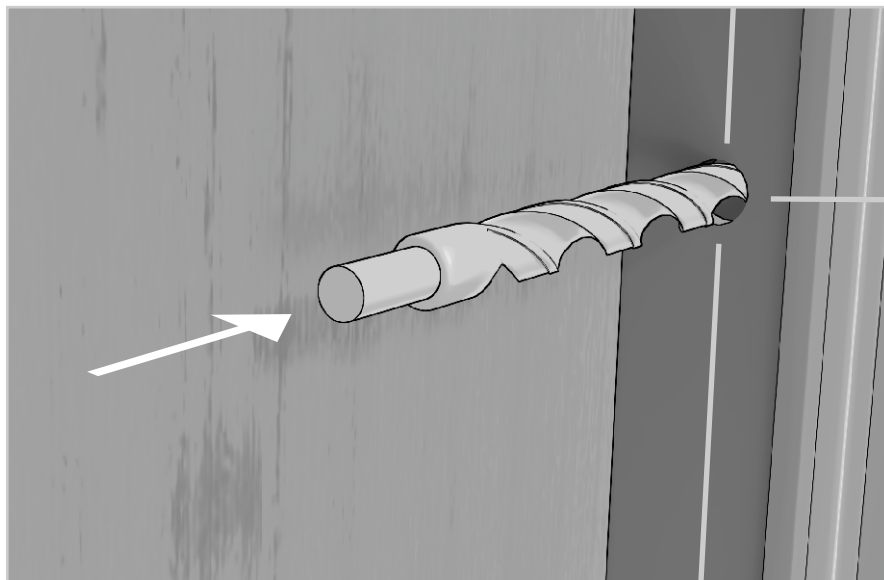

- 4** Attach Frame Cover with provided screws and paint if desired.

